

CITY NORTH

10' ALLEY  
 EX. ASPH. SURFACE  
 EX. STP. (2.5'x6.0')

18  
 N/F SOLVED INC.  
 106 ROBERTS LN.  
 UNIT 200  
 ALEXANDRIA, VA 22314  
 ZONE: CRMU/M  
 INSTR.#050005839

19

20

EX. 1-STORY STUCCO BUILDING #728 N. HENRY STREET

PROPOSED STOOP (4.67'x14.0')

PROPOSED ROOF-TOP DECK

ENCROACHMENT AREA FOR PROPOSED STAIRS TO TOP DECK (4.67'x32.0')

**GENERAL NOTES:**

1. TAX MAP: #054.03-03-05
2. EX. ZONING: CRMU/M
3. OWNER: NAZAR OR MARIE L. SHABBAR  
 6363 OLD DOMINION DRIVE  
 McLEAN, VA 22101  
 DB. 990, PG. 358
4. PLAT SUBJECT TO RESTRICTIONS OF RECORD
5. TOTAL SITE AREA = 2,920 SQ. FT. OR 0.0670 AC.
6. OFF SITE PARKING PROVIDED BY ALEXANDRIA LIGHTING SUPPLY AT #704 N. HENRY STREET.

S 80°39' E ~ 83.42'  
**MADISON STREET**  
 ±66' R/W  
 MONUMENT LINE

S 09°30' W ~ 35'  
**NORTH HENRY STREET**  
 ±66' R/W  
 MONUMENT LINE

**PLAT SHOWING ENCROACHMENTS**

ON LOTS 19 & 20

**J.K.M NORTON &**

**SAML. G. BRENT SUBDIVISION**

(DB. 30, PG. 594)

**CITY OF ALEXANDRIA, VIRGINIA**

SCALE: 1" = 10'

DATE: NOVEMBER 30, 2015

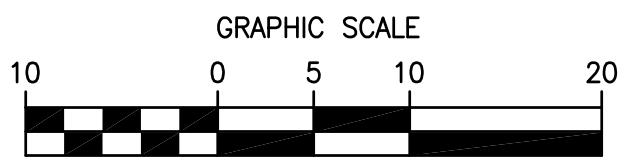
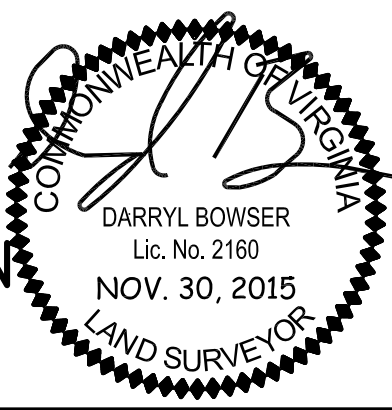

1 INCH = 10 FT.

FILE NO. **15-113**

SHEET **1** OF **1**

COMP.	WDS
DRAWN	WDS
CHECKED	DB



● ENGINEERING ● LAND SURVEYING ● PLANNING  
 730 S. Washington St. Alexandria, Virginia 22314 (703) 549-6422